

# Quick Start Guide

Smart Wire-Free Security Camera

## 01 / Charge the Battery

### Method 1: Battery

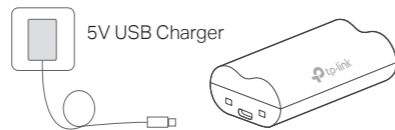

- **Charging:** Solid amber
- **Fully charged:** Solid green

### Method 2: Battery Inside Camera

\*Check the battery status in the Tapo app after setup.

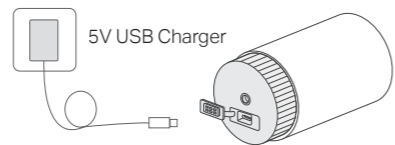

**Note:**

1. Charge the battery before use. It will take about 5~6 hours.
2. If you want to use the camera while charging the battery, we recommend purchasing another battery for your convenience.

## 02 / Insert the Battery

1. Twist anti-clockwise and then pull to remove the cover of the camera. Insert the battery.

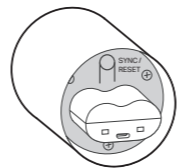

2. Align the indicator line on the cover with the arrow icon on the camera body. Press and rotate clockwise to the lock position to replace the cover.

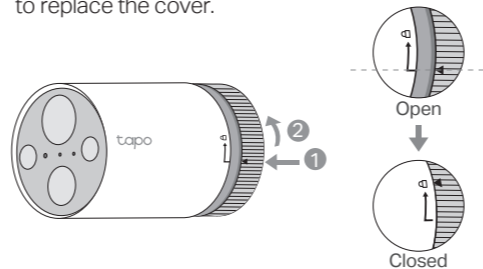

\*Images may differ from your actual products.

## 03 / Set Up the Camera

1. A Tapo Hub is required. Make sure your Tapo Hub is successfully added via the Tapo app.



2. Tap the ⊕ button in the app. Select **Cameras** and then your model. Follow the instructions in the Tapo app to set up your camera.

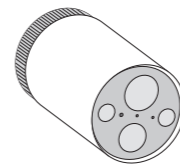

\*Images may differ from your actual products.

## 04 / Installation Options

### Option 1. Set on a Table

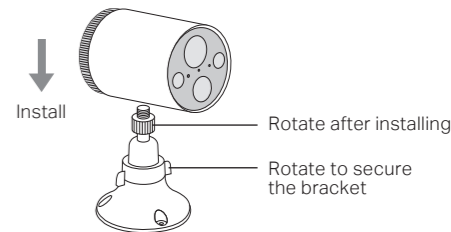

### Option 2. Mount to the Wall

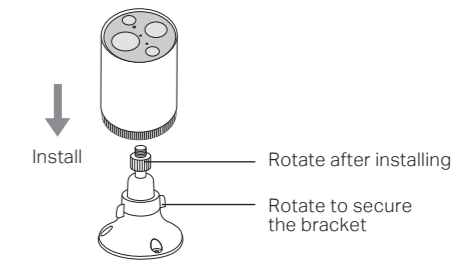

\*Images may differ from your actual products.

# 05 / Mount to the Wall

## 1. Drill Holes

Stick the mounting template to the desired mounting place. Drill 3 holes according to the template.

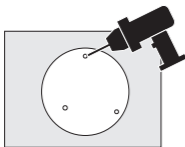

## 2. Install the Bracket

Insert three anchors into the holes and use the screws to affix the bracket over the anchors.

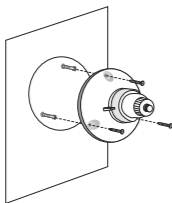

## 3. Install the Camera

Install the camera on the mounting bracket, and adjust the camera angle.

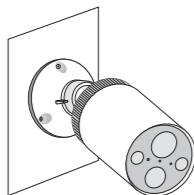

\*Images may differ from your actual product.

## Light Indications

### Camera Status LED

Solid Red	Starting up
Blinking red and green	Ready for pairing
Blinking green slowly	Pairing
Solid amber	Connected to the hub
Solid green	Connected to the cloud
Blinking red quickly	Camera resetting
Blinking green quickly	Camera updating
Blinking red once a minute	Low battery
Blinking red slowly	Offline

### Safety Information

- Do not use damaged charger or USB cable to charge the device.
- Do not use any other chargers than those recommended.
- Do not use the device where wireless devices are not allowed.
- Adapter shall be easily accessible.
- Use only power supplies which are provided by manufacturer and in the original packing of this product. If you have any questions, please don't hesitate to contact us.
- Keep the device away from fire or hot environments. DO NOT immerse in water or any other liquid.
- Do not disassemble, repair or modify the product.
- Do not place near automatically controlled devices such as fire alarms. Radio waves emitted from this product may cause such devices to malfunction resulting in an accident.
- Observe restrictions on using wireless products in fuel depots, chemical plants or when blasting operations are in progress.
- Do not use liquid to clean the product. Only use a dry cloth.
- Never put metal objects inside the product. If a metal object enters the product turn off the circuit breaker and contact an authorised electrician.
- This product is not intended to be used when providing medical care. Consult the manufacturer of any personal medical devices, such as pacemakers or hearing aids to determine if they are adequality shielded from external RF (radio frequency) energy.
- Do not use this product in health care facilities. Hospitals or health care facilities may be using equipment that could be sensitive to external RF energy.
- Do not place heavy objects on top of the product.
- When you leave the product unused for a long time unplug the product from the power outlet.
- Product should be kept away from heat sources such as radiators, cookers etc. - it should not be placed in places where the temperature is less than -20 degrees or greater than 45 degrees.
- This product may interfere with other electronic products such as TV, radios, personal computers, phones or other wireless devices.
- Always follow the local waste and recycle laws when you get rid of the used battery.

### CAUTION!

Risk of fire or explosion  
if the battery is replaced by an incorrect type

### CAUTION!

Avoid replacement of a battery with an incorrect type that can defeat a safeguard.  
Avoid disposal of a battery into fire or a hot oven, or mechanically crushing or cutting of a battery, that can result in an explosion.  
Do not leave a battery in an extremely high temperature surrounding environment that can result in an explosion or the leakage of flammable liquid or gas; Do not leave a battery subjected to extremely low air pressure that may result in an explosion or the leakage of flammable liquid or gas.

Operating Temperature: -20 °C ~ 45°C (-4°F ~ 113°F)  
Operating Humidity: 10%~90%RH, Non-condensing  
Please read and follow the above safety information when operating the device. We cannot guarantee that no accidents or damage will occur due to improper use of the device. Please use this product with care and operate at your own risk.

TP-Link hereby declares that the device is in compliance with the essential requirements and other relevant provisions of directives 2014/53/EU, 2009/125/EC, 2011/65/EU and (EU)2015/863.

The original EU declaration of conformity may be found at <https://www.tapo.com/support/ce>

TP-Link hereby declares that the device is in compliance with the essential requirements and other relevant provisions of the Radio Equipment Regulations 2017.

The original UK declaration of conformity may be found at <https://www.tapo.com/support/ukca/>



## Need some help?

Visit [www.tapo.com/support](http://www.tapo.com/support)

for technical support, user guides, FAQs,  
warranty & more